

本圖面若與目錄之規格尺寸不符，以本圖面規格尺寸為主。
Below is our main specification if different from catalog.

RoHS compliant

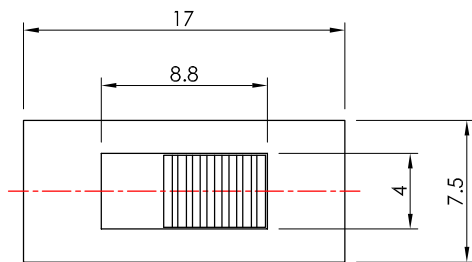

SCHEMATIC (NON-SHORTING)

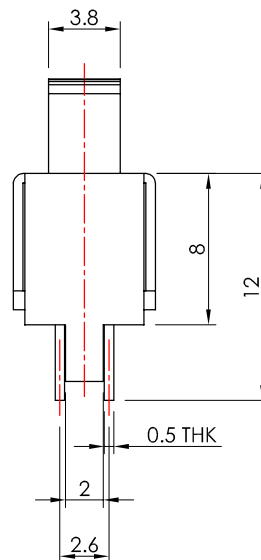
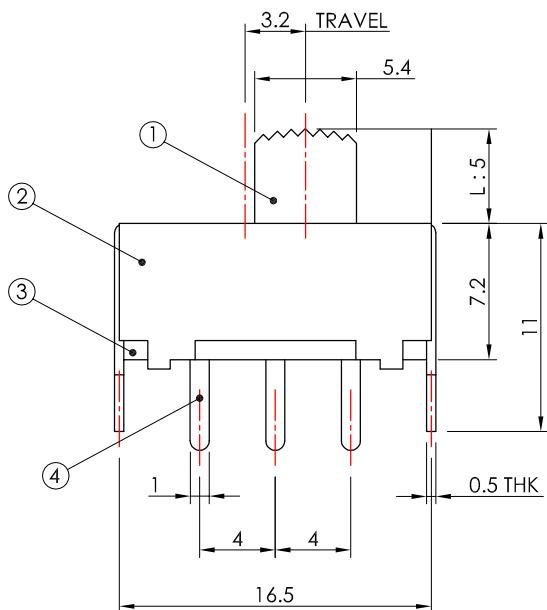
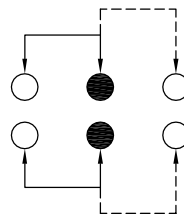

P.C.B. LAYOUT

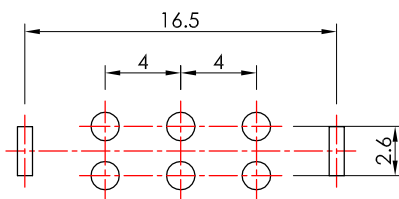

SPECIFICATION

- Rating:** 0.5A 50V DC.
- Contact resistance:** 30mΩ Max. (initial)
- Insulation resistance:** 100MΩ at 500V DC.
- Withstand voltage:** 500V AC for 1 minute.
- Operating force:** 250±100g.
- Minimum load:** 30mA 10V DC. (reference only)
- Switching life:** 10,000 Cycles (unloading/15-18 Cycles per minute).
- Soldering temperature:** 230°C Max for 2±0.5 Sec.
- Soldering time:** 1 time only.
- Note:** Not washable, don't immerse into epoxy and organic solvent.

MATERIAL

- Knob:** POM, black. ————— ①
- Frame:** Steel strip, Ni plated. ————— ②
- Terminal base:** Phenolic resin, natural. ————— ③
- Terminal:** Brass strip, Ag plated over Ni plated. ————— ④
- Spring:** Steel wire, temper.
- Contact:** Copper strip, Ag plated.

RoHS compliant

SS22F06GX-G

OPTIONAL KNOB SIZE (L)
4-10



V2.1	△		
V2.0	無	新繪製	2009.12.03
版本 VER.	符號 SYMBOL	修改內容 ALTERATION	更新日期 DATE

產品 PRODUCT		Slide Switch		型號 MODEL NO.		SS22F06G5-G	
比例 SCALE	5:2	單位 UNIT	mm	<p>一綺電子企業股份有限公司</p> <p>總公司：110 台北市信義路四段415號12樓之2 12F-2 NO. 415, SEC. 4, HSIN YI ROAD, TAIPEI, TAIWAN TEL: 886-2-27290229 (Rep.) FAX: 886-2-27582086 URL: http://www.switronic.com.tw E-MAIL: switches@ms36.hinet.net</p>			
公差 TOLERANCE	.X=±0.3mm, .XX=±0.2mm						
製圖 DRAWN BY	核圖 CHECKED BY	主管 APPROVED BY					
Jan Chiu	Alex Lin	Margaret Lee					